

INSTALLATION GUIDE:

130 mm IP65 BEZEL
990.0301.01



IMPORTANT:

The luminaire must not be covered by any debris or insulating material. Ensure there is a minimum of 50 mm airspace around the luminaire and control gear. Electrical termination must be carried out by a qualified electrician in accordance with the latest edition of IEE wiring regulations BS7671.

PLEASE RETAIN THIS GUIDE FOR FUTURE REFERENCE AND RECYCLE PACKAGING.

A ISOLATE MAINS SUPPLY BEFORE COMMENCING INSTALLATION

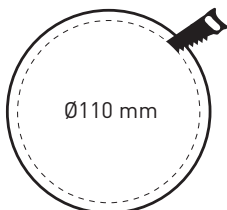

- Cut a 110 mm circular hole at the desired location using a holesaw.

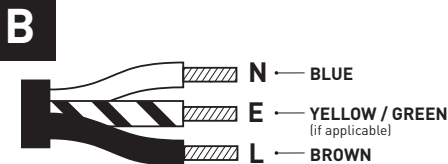

- Connect the luminaire to the mains supply using a terminal block (not supplied) compliant with the requirements of EN60998-2-1 or 2-2.
- Install the driver into the ceiling void, ensuring it is not covered by any debris or insulating material.

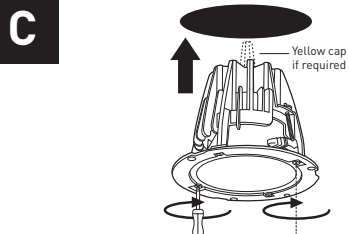

- Offer the luminaire into the ceiling void without using the rubber gasket. If there is a risk of the heatsink being covered, please insert a yellow cap into the top of the luminaire.
- Turn the 2 fixing screws clockwise to secure, leaving a 5 mm gap off the ceiling. **DO NOT USE POWER TOOLS.**

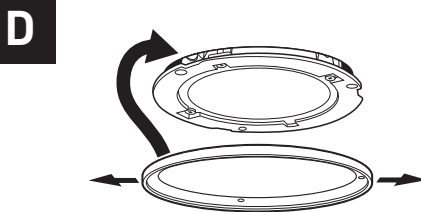

- Stretch the rubber gasket over and behind the lip of the luminaire, ensuring the gasket lip is facing downwards and that the 3 holes in the gasket are aligned to the 3 holes on the luminaire as shown.

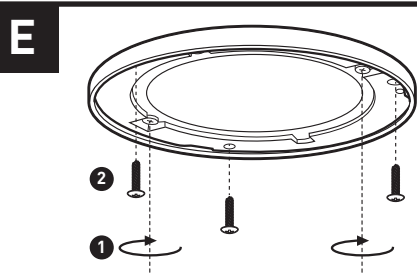

- Re-tighten the 2 fixing screws (1) until luminaire is secure. Please ensure these screws are set to a torque setting of between 0.4 - 0.5 Nm.
- Using the screws supplied (2), screw the gasket to the luminaire via the 3 aligned holes until secure to ceiling.

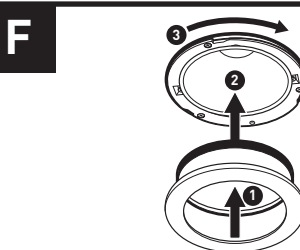

- Remove film from both sides of polycarbonate lens and locate with rubber seal behind the twist and lock bezel (1).
- Install the twist and lock bezel, ensuring the rubber gasket lip is not trapped and is around the bezel (2,3).



REINSTATE MAINS SUPPLY