

INSTALLATION GUIDE:

EXTRUDED DIRECT LINEAR - SURFACE MOUNTED
990.0365.01



IMPORTANT:

Electrical termination must be carried out by a qualified electrician in accordance with the latest edition of IEE wiring regulations BS7671.

ENSURE MOUNTING SURFACE IS CAPABLE OF SUPPORTING THE WEIGHT OF THE LUMINAIRE

PLEASE RETAIN THIS GUIDE FOR FUTURE REFERENCE AND RECYCLE PACKAGING.

A ISOLATE MAINS SUPPLY BEFORE COMMENCING INSTALLATION

0.85 m Length 2.5 kg

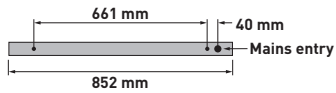

1.2 m Length 3.5 kg



1.5 m Length 4.3 kg



2.5 m Length 7.3 kg

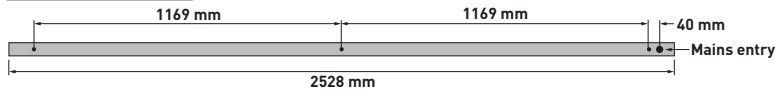

IMPORTANT: DO NOT USE POWER TOOLS TO TIGHTEN FIXINGS ON THIS LUMINAIRE

- Ensure the mounting surface is flat and even.
- Mark out positions of fixing holes on ceiling, depending upon length of luminaire.
- If suspended, see separate installation guide 990.0372.01 for suspension installation.

On emergency converted 2.5 m lengths, only the LED tray containing the charge indicator will illuminate in emergency mode

D

- Disconnect the driver connectors and the earth spade to release the LED tray.
- Offer the luminaire body up to the ceiling and feed mains cable into it.
- Attach the luminaire body to the ceiling using suitable fixings (not supplied).
- If suspended, see separate installation guide 990.0372.01 for suspension installation.

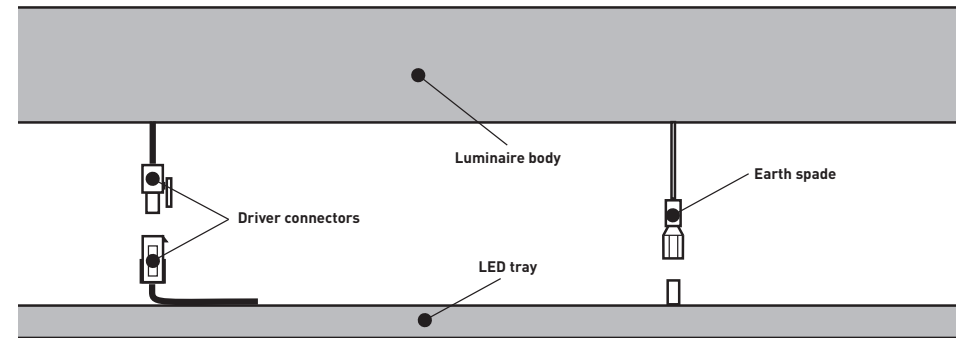

B

- Prise out the diffuser using a plastic lever tool (not supplied) or card, starting in the centre of the diffuser and working outwards.
- Please note: Do not use metal tools such as screwdrivers to do this as they may damage the diffuser / body

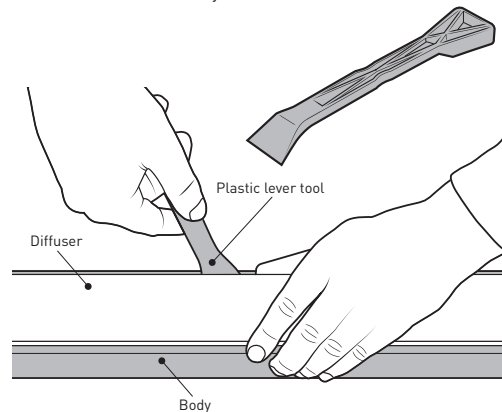

C

- Using a terminal driver, ease out the LED tray retaining clips, whilst pulling the tray up, one at a time and remove the downlight LED tray as shown.
- Slide tray to one end and remove

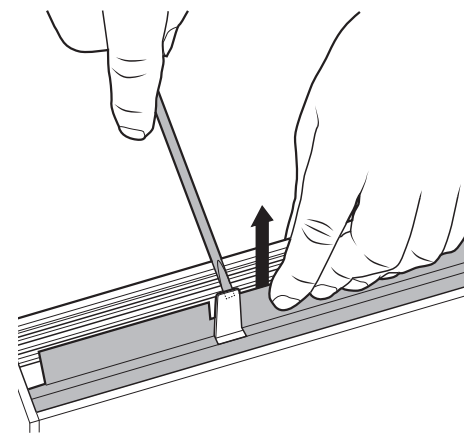

E

- Connect mains supply to terminal block.
- For switch dim, link D2 to N and connect D1 to mains supply via a push to make retractive switch.

STANDARD

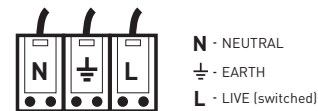

EMERGENCY

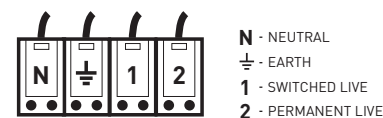

DIMMING



F

- Offer up the LED tray and reconnect the driver connectors and the earth spade.
- Push the LED tray into the body ensuring the clips are correctly aligned and secure and no wires are trapped.
- Push the diffuser back into the luminaire until secure.

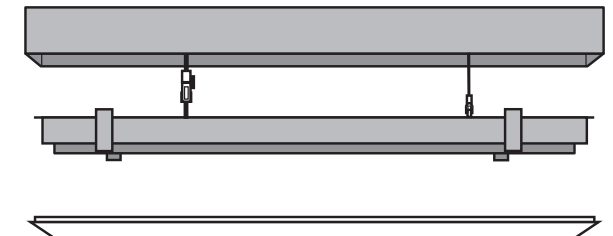

REINSTATE MAINS SUPPLY

INSTALLATION GUIDE:

SUSPENDED DIRECT LINEAR - JOINING KITS

990.0374.01



IMPORTANT:

Electrical termination must be carried out by a qualified electrician in accordance with the latest edition of IEE wiring regulations BS7671.

PLEASE RETAIN THIS GUIDE FOR FUTURE REFERENCE AND RECYCLE PACKAGING.

IN-LINE JOINT

PERFORM INSTALLATION BEFORE CLIPPING
GEAR TRAY AND DIFFUSER BACK INTO LUMINAIRE

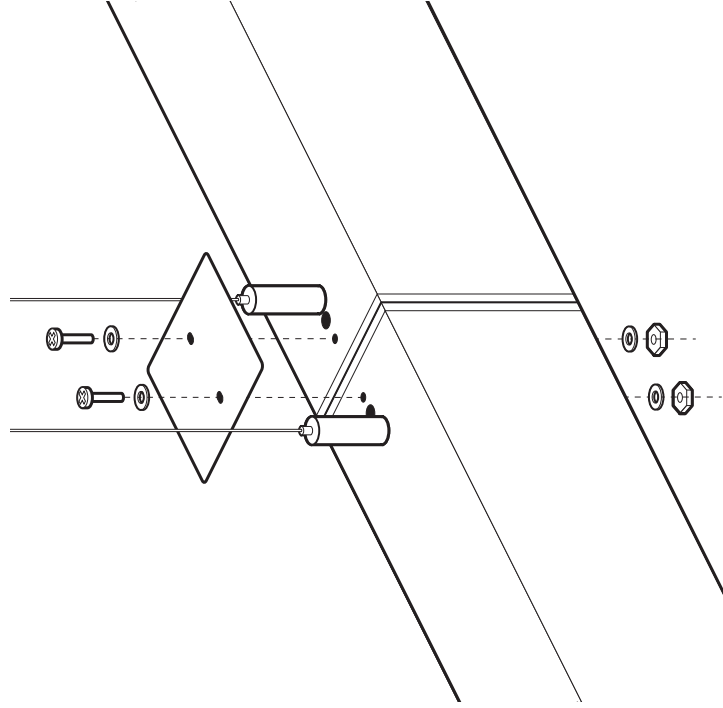

90° JOINT

PERFORM INSTALLATION BEFORE CLIPPING
GEAR TRAY AND DIFFUSER BACK INTO LUMINAIRE

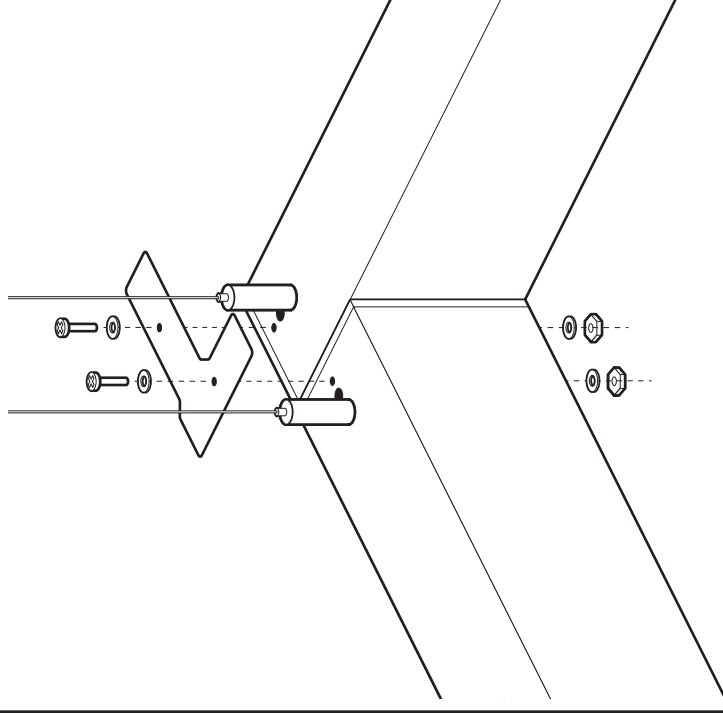

INSTALLATION GUIDE:

EXTRUDED DIRECT LINEAR - SUSPENSION KIT
990.0372.01



PLEASE RETAIN THIS GUIDE FOR FUTURE REFERENCE AND RECYCLE PACKAGING.

IMPORTANT:

Electrical termination must be carried out by a qualified electrician in accordance with the latest edition of IEE wiring regulations BS7671.

ENSURE MOUNTING SURFACE IS CAPABLE OF SUPPORTING THE WEIGHT OF THE LUMINAIRE.

A ISOLATE MAINS SUPPLY BEFORE COMMENCING INSTALLATION

IMPORTANT: DO NOT USE POWER TOOLS TO TIGHTEN FIXINGS ON THIS LUMINAIRE

0.85 m Length 2.5 kg

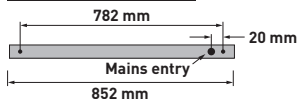

1.2 m Length 3.5 kg

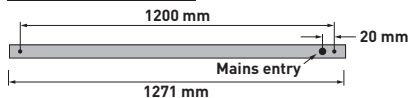

1.5 m Length 4.3 kg

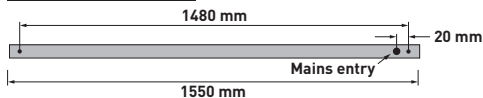

2.5 m Length 7.3 kg

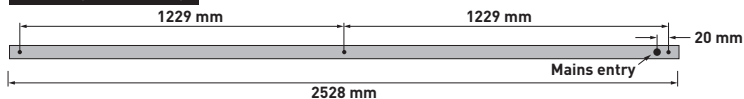

- Mark out positions of fixing points on ceiling, depending upon length of luminaire.
- Attach the ceiling cup assemblies to the ceiling using suitable fixings (not supplied).

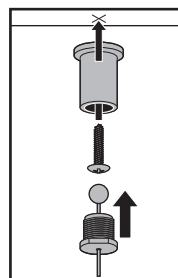

- ### B
- Follow luminaire installation guide 990.0365.01 steps **B**, **C** & **D** (1st point only)
 - Attach the suspension clutches and cable gland as shown

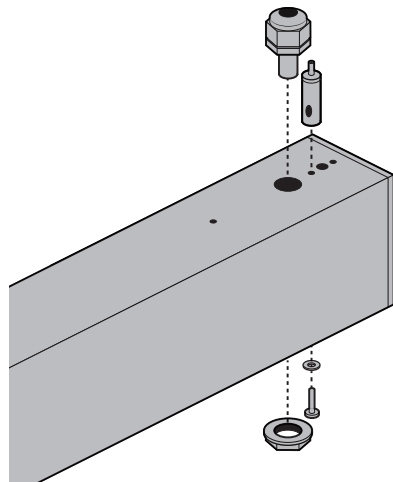

- ### C
- Offer the luminaire up to the required position
 - Thread the suspension cables through the suspension clutches
 - Level the luminaire (to adjust the luminaire downwards, support the weight of the luminaire then press down the nipple to release the clutch)
 - Feed the mains cable into the luminaire and secure the cable gland
 - Continue to follow luminaire installation guide 990.0365.01 from step **E**

