

INSTALLATION GUIDE:

PANEL PENDANT
990.0343.01



IMPORTANT:

The luminaire must not be covered by any debris or insulating material. Ensure there is a minimum of 50 mm airspace around the luminaire. Electrical termination must be carried out by a qualified electrician in accordance with the latest edition of IEE wiring regulations BS7671.

PLEASE RETAIN THIS GUIDE FOR FUTURE REFERENCE AND RECYCLE PACKAGING.

A



ISOLATE MAINS SUPPLY BEFORE COMMENCING INSTALLATION

600 mm luminaire
(3 mounting points)

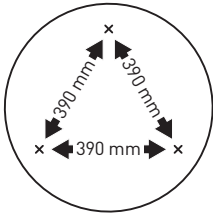

1200 mm luminaire
(4 mounting points)

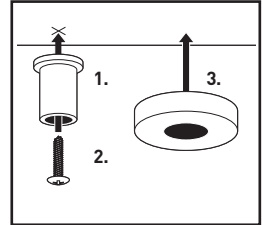
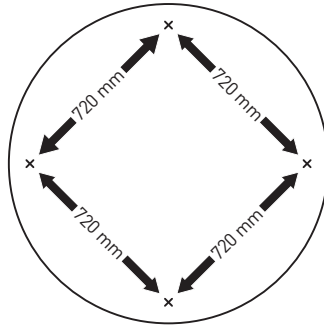

6.5 kg - 600 mm luminaire

22 kg - 1200 mm luminaire

ENSURE MOUNTING SURFACE IS CAPABLE OF SUSPENDING THE WEIGHT OF THE LUMINAIRE

- Disassemble ceiling mounts (1), then attach to ceiling as indicated using suitable fixings (2) in desired location.
- Install ceiling rose using suitable fixings adjacent to a ceiling mount for power connection point (3).

B

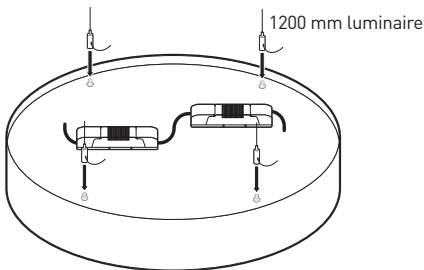
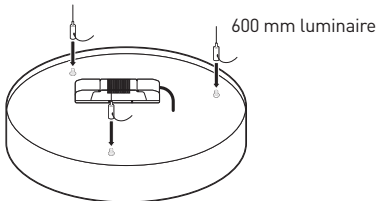

- Screw suspension clutches on to studs on the back of luminaire. Three suspension clutches for 600 mm luminaire or four for 1200 mm luminaire.

C

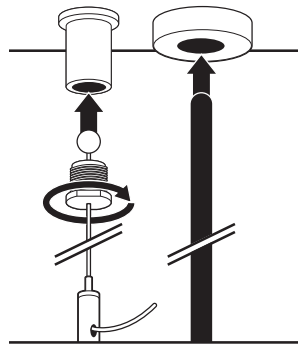

- Reassemble ceiling mounts.
- Raise luminaire to the desired height.
- Connect the luminaire to the mains supply using a terminal block (not supplied) compliant with the requirements of EN60998-2-1 or 2-2.



REINSTATE MAINS SUPPLY